



INIZIATIVE INDUSTRIALI ITALIANE

S.p.A.

(METEOR S.p.A.)

Viale Gorizia n. 6 - 00198 ROMA

• TEL. +39.06.8415821

• FAX +39.06.8557162

## SKY ARROW 1450L (650T) KIT DESCRIPTION

*Effective*

*June 1<sup>st</sup>, 2000*

### PART A – KIT SECTIONS

Item	Production identification	Description
1	<b>SKY ARROW 1450L KIT  UNPOWERED SECTION</b>	<p>This SECTION includes all the following subkits which provide the basic materials and parts for the airframe. Some standard parts must be purchased from other suppliers or fabricated by the builder.</p> <p><b>Breakdown:</b></p> <p>Subkit 1: Fuselage 90% completed, control links installed, rudder, canopy and seats</p> <p>Subkit 2: Instrument panel (shell + panel empty + connectors)</p> <p>Subkit 3: Main electrical system (drawings instructions and main connectors)</p> <p>Subkit 7: Metal wing with struts (90% completed)</p> <p>Subkit 8: Metal horizontal tail (85% completed)</p> <p>Subkit 9: Composite main gear and metal nose gear (without wheels)</p> <p>Subkit 10: Documentation (partial)</p>
<p>NOTE: For more details refer to the current version of PTU/CAD 0200P/CD valid at the time a contract is signed. When placing the order you may also buy any of the “basic level” or “ready to install” options indicated in section B. For the dimensions and performance of the resulting aircraft see the PTU/CAD.</p>		

Item	Production identification	Description
2	<b>SKY ARROW 1450L KIT</b>  <b>ROTAX 912 ULS POWERED NOT ASSEMBLED SECTION</b>	This SECTION of the SKY ARROW 1450L KIT provides the 100 HP Rotax 912 engine and most of the hardware necessary for engine installation. Some parts must be fabricated by the builder using drawing instructions and raw material provided by the manufacturer.  <b>Breakdown:</b> Subkit 4: 912 engine equipment Subkit 5: 912 engine with aux. alternator Subkit 6: fixed pitch propeller Subkit 10: documentation (part)
3	<b>SKY ARROW 1450L KIT</b>  <b>ROTAX 912 ULS POWERED ASSEMBLED SECTION</b>	Same as item 2 but supplied in assembled form.
4	<b>SKY ARROW 1450L KIT</b>  <b>ROTAX 914 UL POWERED NOT ASSEMBLED SECTION</b>	This SECTION of the SKY ARROW 1450L KIT provides the 115 HP turbocharged Rotax 914 and most of the hardware necessary for engine installation. Some parts must be fabricated by the builder using drawings instructions and raw material provided by the manufacturer.  <b>Breakdown:</b> Subkit 4a: 914 engine equipment Subkit 5a: 914 engine with aux. alternator. Subkit 6a: in flight adjustable propeller Subkit 10: documentation (part)
5	<b>SKY ARROW 1450L KIT</b>  <b>ROTAX 914 UL POWERED ASSEMBLED SECTION</b>	Same as item 4 but supplied in assembled form.

- **For the OPTIONS (both “BASIC LEVEL” or “READY TO INSTALL”) or ACCESSORIES see part B and C**

## PART B – “BASIC LEVEL” AND “READY TO INSTALL” OPTIONS

### Subkit # 1 - Fuselage with secondary electrical system

#### **1.A Basic level**

(With these options the homebuilder can buy miscellaneous standard parts that are usually purchased from other suppliers and that are not included in the kit. These items are grouped by major component groups shown below).

<i>Item</i>	<i>Related to</i>
1.A.1	Bare fuselage with bulkheads
1.A.2	Canopy and rear side windows
1.A.3	Front and rear seats with belts
1.A.4	Pitot system
1.A.5	Fuel system
1.A.6	Brake master cylinder
1.A.7	Firewall
1.A.8	Cockpit heater
1.A.9	Right and left controls
1.A.10.	Front rudder pedals
1.A.11.	Rear rudder pedals
1.A.12.	Flaps control
1.A.13.	Rudder control system
1.A.14.	Reinforcement tubes
1.A.15.	Miscellaneous

#### **1.B Ready to install**

(With these options the homebuilder can buy the items listed below in a ready to install form. These options include the standard materials either supplied for each item in the kit or as part of the relevant “Basic Level option”).

**Items 1.A are included in the items listed below.**

<i>Item</i>	<i>Description</i>	<i>Priority</i>
1.B.1.	Front rudder pedals (see next page)	1
1.B.2.	Rear rudder pedals (see next page)	1
1.B.3.	Tail skid	3
1.B.4.	Blue canopy bonded on its frame, and removable blue side windows	3
1.B.5.	Firewall (three pieces)	3
1.B.6.	Fuselage prepared, trimmed with gelcoat, and with cockpit floor bonded	3
1.B.7.	Reinforcement tubes	3
1.B.8.	Flaps control (see next page)	2
1.B.9.	Brake master cylinder assembly	2
1.B.10.	Metal part for front and rear seat	3

#### **Special**

1.B.11.	Completed and finished (gelcoated) fuselage with secondary electrical system, and all control lines already installed (subkit 1 completed)
---------	--

#### **Combined**

1.B.12.	Completed and finished (gelcoated) fuselage with main and secondary electrical system, and all control lines already installed (subkit 1 and 3 completed and assembled)
---------	---

NOTE: To allow for a reduction in assembly hours, all the above “Ready to Install” options have been classified in 3 priorities. Priority 1 is highly suggested and reduces the working time about 20%. Priority 2 further reduces working time an additional 30%. Priority 3, if combined with the other two, brings the working hours to a minimum.

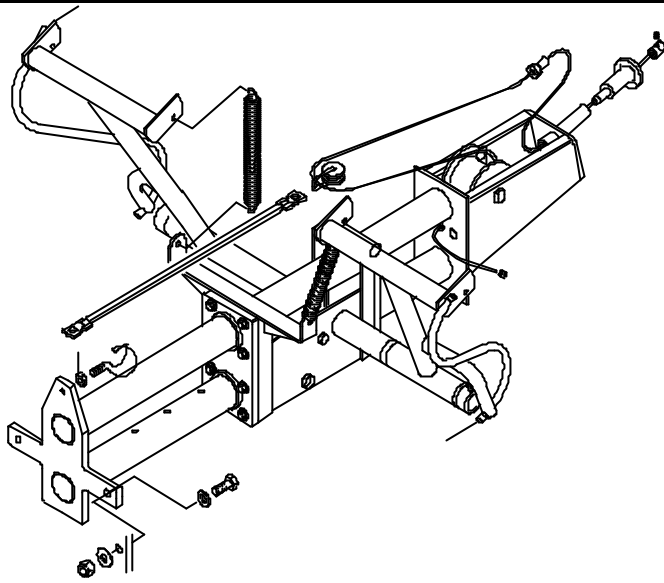

Option 1.B.1: Front rudder pedals

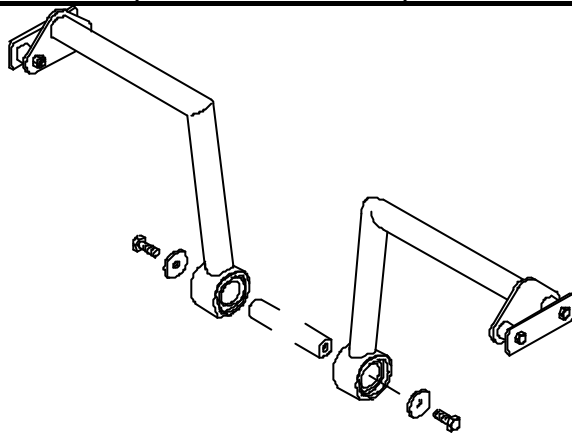

Option 1.B.2: Rear rudder pedals

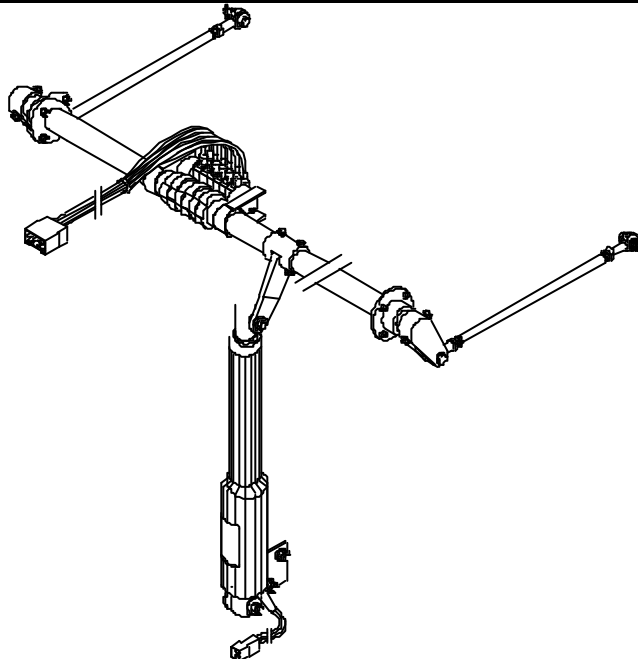

Option 1.B.8: Flaps control

## **Subkit # 2 - Instrument panel with related electrical system**

- 2.A Basic level** (These options allow the homebuilder to buy flight instruments and avionics in an unassembled form directly from the kit manufacturer.)

<i>Item</i>	<i>Related to</i>
2.A.1	Flight, and engine instrument section
2.A.2	Avionics section (transponder, blind encoder, NAV/COM, intercom, antennas & installation kits)
2.A.3	Connectors and wiring parts
2.A.4	Nuts, bolts, and miscellaneous parts

- 2.B Ready to install** (This option provides the homebuilder with a completely assembled instrument panel with instruments and avionics installed directly from the kit manufacturer.)  
**Items 2.A are included in the items listed below.**

### **Special**

<i>Item</i>	<i>Description</i>
2.B.1.	Instrument panel in standard configuration (including flight and engine instruments, and avionics) fully finished.

## **Subkit # 3 - Main electrical system**

- 3.A Basic level** (With this option the homebuilder can buy from the kit manufacturer the standard materials not included in the kit and that should be bought from other suppliers.)

<i>Item</i>	<i>Related to</i>
3.A.1.	Miscellaneous: nuts, bolts, connectors, and wiring

- 3.B Ready to install** (With this option the homebuilder can buy a fully assembled main electrical system.)  
**Items 3.A are included in the items listed below.**

<i>Item</i>	<i>Description</i>
3.B.1.	Main electrical system harness completely assembled and ready to install

## **Subkit # 7 - Metal wing with struts**

- 7.A Basic level** (This option provides all the materials to complete the metal wing that are normally purchased from other vendors.)

<i>Item</i>	<i>Related to</i>
7.A.1.	Fabric coating and finishing materials

- 7.B Ready to install** (This option provides a completed set of metal wings and struts ready to be installed.)  
**Items 7.A are included in the items listed below.**

<i>Item</i>	<i>Description</i>
7.B.1.	Set of finished struts
7.B.2.	Aluminum wing completely finished and ready to install.

**Special - Composite wings**

<i>Item</i>	<i>Related to</i>
7.B.3.	Carbon composite wing completely finished and ready to install <u>Note:</u> This option substitutes a composite wing for the standard metal wing. The price of the metal wing kit has been deducted.

**Subkit # 8 - Metal horizontal stabilizer and its electrical system**

**8.A Basic level** (This option provides all of the parts and materials necessary to complete the horizontal stabilizer and the associated trim system)

<i>Item</i>	<i>Related to</i>
8.A.1.	Fabric coating and finishing materials, and trim actuator electrical system

**8.B Ready to install**

**Special**

<i>Item</i>	<i>Description</i>
8.B.1	Carbon composite horizontal tail completely finished and ready to install <u>Note:</u> This option substitutes a composite horizontal stabilizer for the standard metal horizontal stabilizer.

**Subkit # 9 – Landing gear**

**9.B Ready to install** (With this option the homebuilder can buy from the kit manufacturer in a ready to install form, the front and main landing gear fully finished.)

<i>Item</i>	<i>Description</i>
9.B.1	Front and main landing gear with composite main leafs completely finished

## PART C - "ACCESSORIES"

The following equipment, are not supplied with the kit and are not listed as parts to be acquired outside because not included in the standard configuration. These items can be ordered from the kit manufacturer.

(A = Applicable - N/A = Not Applicable)

Id. N	Description	Weight (lbs.)	Applicable to	
			650 / 912	650 / 914
<b>ENGINE ACCESSORIES</b>				
C.1.1	Vacuum pump kit with related accessories including pressure gauge	4	(*)	(*)
C.1.2	Drive to be installed inside the reduction gear of Rotax engine to operate vacuum pump (without installation)	1	(*)	(*)
<b>ON BOARD ACCESSORIES</b>				
C.2.1	Seat cushions (sets of 2)	2	A	A
C.2.2	Under front seat documents box	1	A	A
C.2.3	Under 2nd seat luggage storage container	3	A	A
C.2.4	Behind rear seat luggage storage container	4	A	A
C.2.5	Adjustable mirror	0,5	A	A
C.2.6	N° 3 aerodynamic covers for main landing gear	3	A	A
C.2.7	GPS with colored moving map	2	A	A
C.2.8	Glider or banner towing kit including camera and monitor	22	A	A
C.2.9	Rear seat instruments for training purpose	13	A	A
C.2.10	Kit for disabled pilots	10	A	A
<b>MARINE ACCESSORIES</b>				
C.3.1	1. Float conversion kit	100	A	A
C.3.2	2. Amphibious conversion kit	210	N/A	A
<b>GROUND ACCESSORIES</b>				
C.4.1	Waterproof white canvas cover for canopy and engine	-	A	A
C.4.2	Set of retainers for ailerons, flaps and rudder	-	A	A
C.4.3	Set of stakes and ropes for aircraft tie down	-	A	A
C.4.4	Set of fixtures to move and store the aircraft with folded wings (5 pieces)	-	A	A
C.4.5	On-road aircraft transportation trailer (with wings and horizontal stabilizer disassembled), hydraulic loading system (requires item # 4)	-	A	A
C.4.6	Maintenance tools set	-	A	A

(\*): Only if vacuum instruments are installed. Option 2.A.1.